

## ISOMETRIC VIEWS

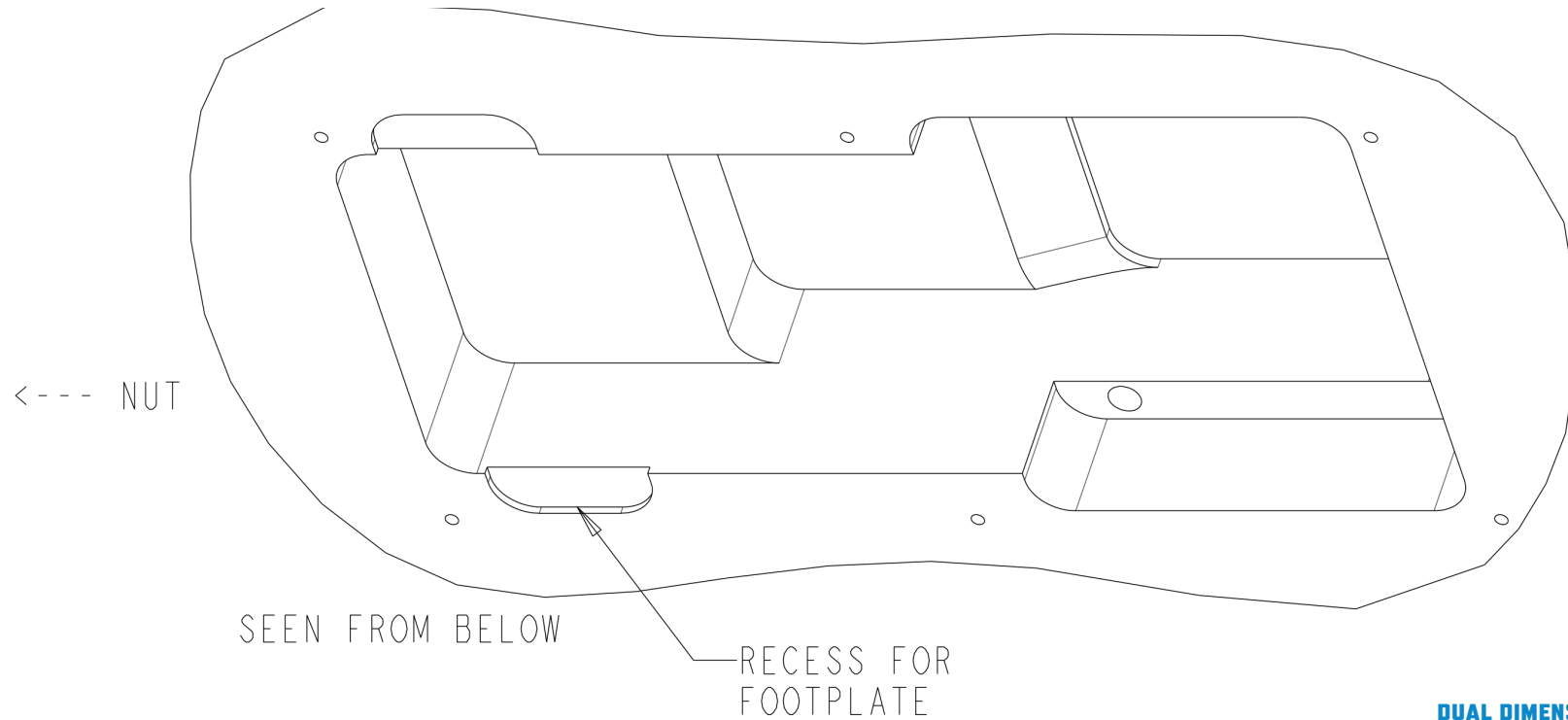
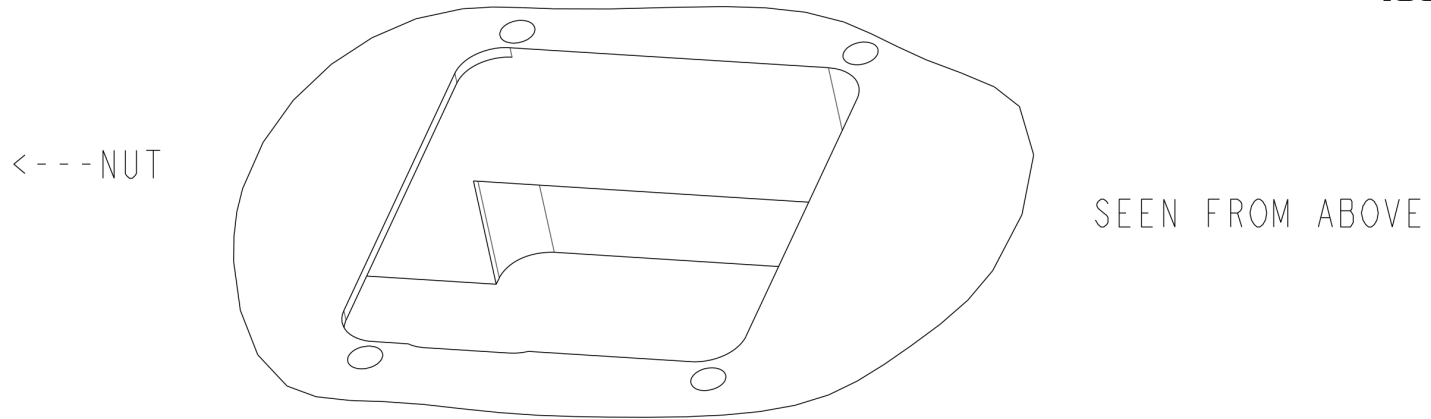

**TOP VIEW SHEET**

1). FOUR MOUNTING HOLES  
 AND POCKET ARE ROUTED  
 THROUGH FULL DEPTH OF BODY

<--- NUT

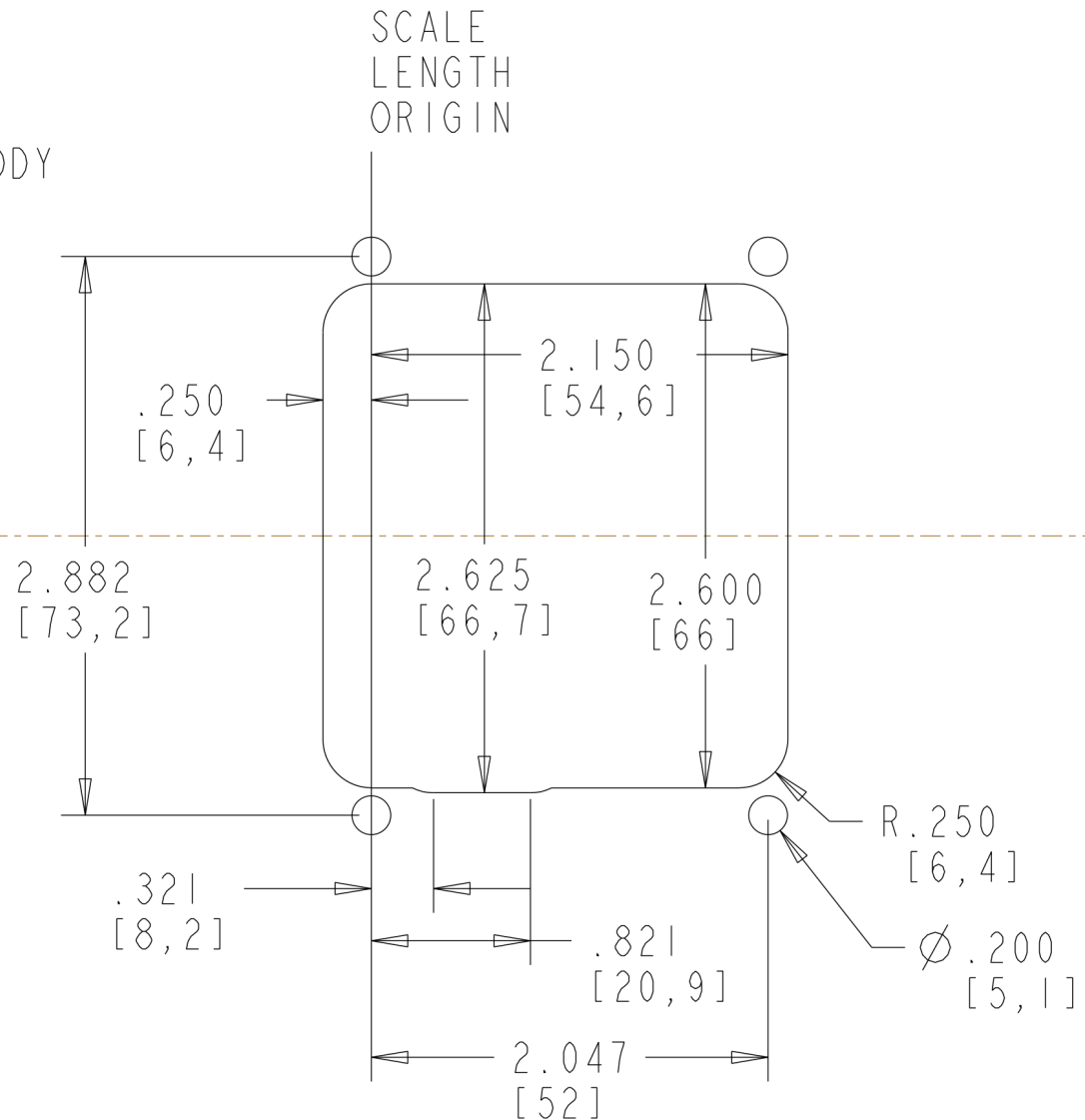

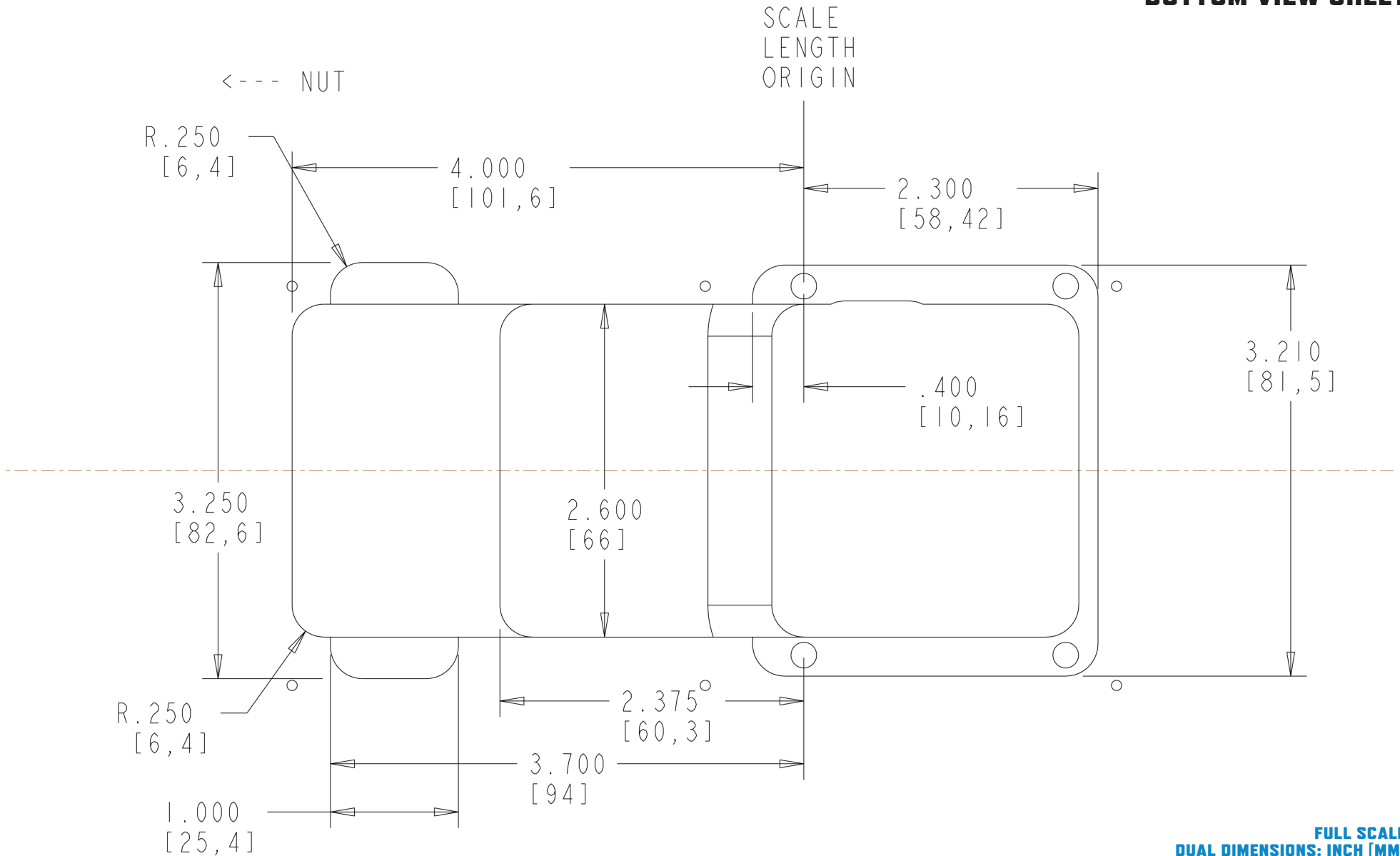
**BOTTOM VIEW SHEET**

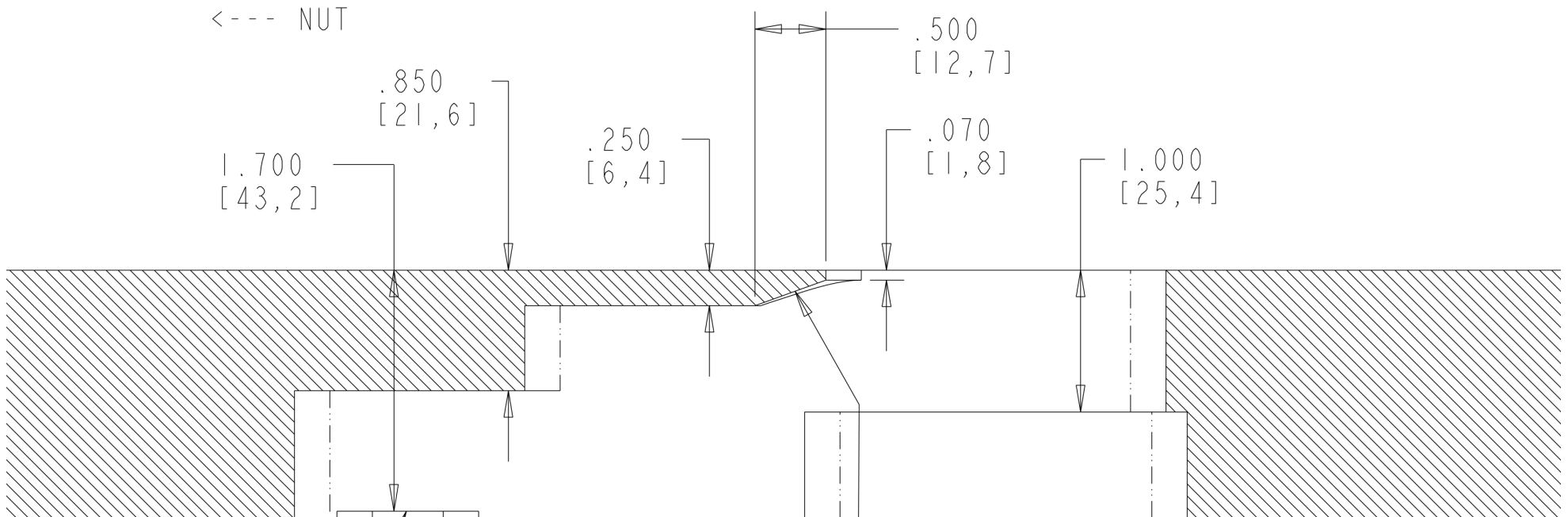
**SECTION VIEW SHEET**

RECESS FOR  
FOOTPLATE

1). .250" THICK CHAMFERED WOOD  
SECTION BETWEEN BRIDGE ROUTE  
AND BRIDGE PICKUP CAN BE REMOVED  
FOR APPLICATIONS WITH PICKGUARDS

**BOTTOM VIEW SHEET**

1). SPOT DRILL SIX PLACES FOR BACKPLATE SCREWS

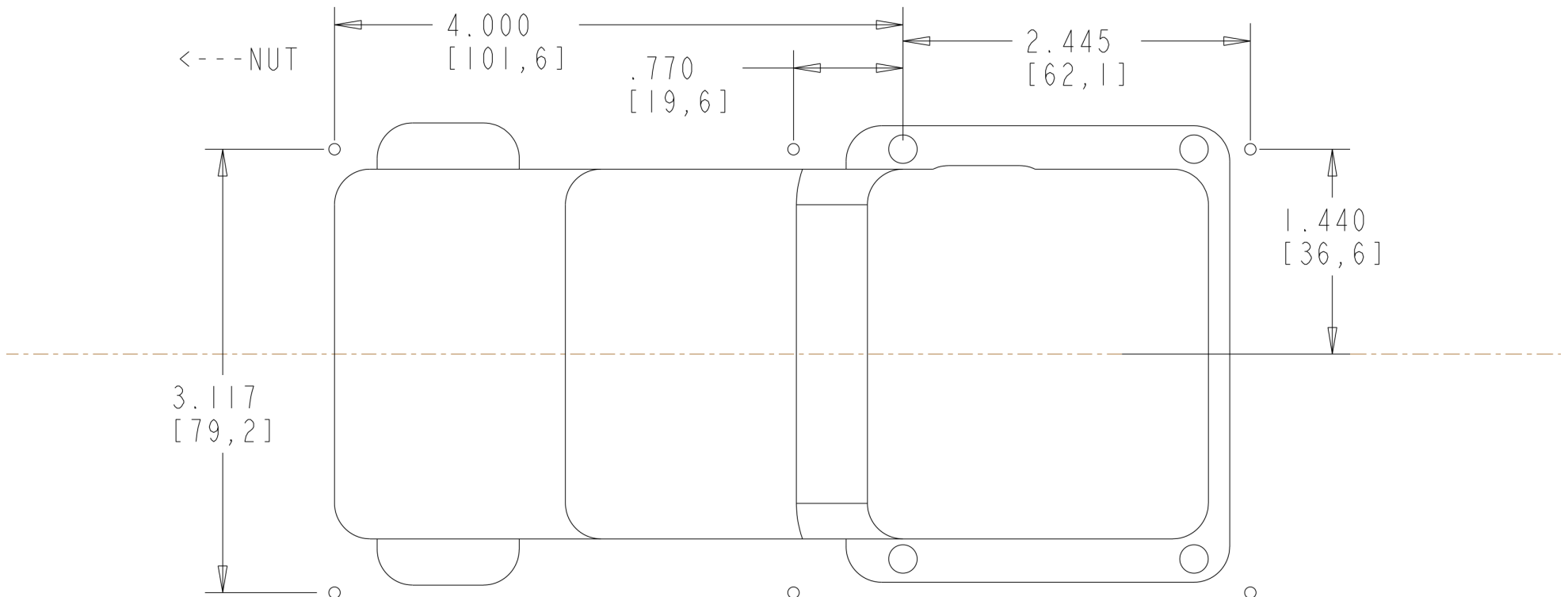

2). FOR RETROFITS TO GUITARS ALREADY ROUTED FOR STANDARD TREM, USE THIS ASSYMETRICAL BACKPLATE HOLE PATTERN.

3). FOR GUITARS WITHOUT PREVIOUS TREM ROUTES, USE HOLE PATTERN SHOWN FOR THE "ET001T" AND USE THE SYMMETRICAL ET001T BACKPLATE.